

## VADER 210



Industrial High Bay IP65 luminaire. Diffuser-high quality lens optics. Top quality SMD LED modules with colour consistency MacAdams 3, extensive portfolio of lumen ranges, CCTs and spectra. Variety of drivers: standard EVG on/off or DALI. Mounting on suspension set for any type of ceiling. Body is made of aluminium. Standard colour RAL 9005M, other colours on request. Variety of beam angles, lumen outputs and drivers allows to use this luminaire in different types of lighting projects.

Luminous flux & Luminaire Power tolerance up to 10%. System power consumption depends on components used. Luminous efficacy depends on type of LED's, electronics, optics and diffuser. The most up to date technical parameters can be found on our website and in database of LDT files.

Lighting direction



PDF datasheet:



# VADER 210

<b>Mounting:</b>	Suspended / surface mounted
<b>Body material:</b>	Aluminium
<b>Colour:</b>	Standard black RAL 9005M, other RAL colours on request
<b>Lumen output:</b>	Standard up to 7000 lm, any other on request
<b>LED module:</b>	Signify (Philips), Tridonic or equivalent SMD LED module
<b>Colour temperature:</b>	3000/4000K, other on request
<b>Colour Rendering:</b>	CRI>80 in standard, other on request
<b>Driver:</b>	EVG on-off, DALI, other on request
<b>Wireless controll:</b>	N/A
<b>Daylight/Occupancy sensor:</b>	N/A
<b>Emergency unit:</b>	N/A
<b>Operating temperature range:</b>	-25°C ... +45°C
<b>IP Class:</b>	IP65 in standard
<b>Power:</b>	220-240V 50/60Hz
<b>Lighting direction:</b>	Direct lighting
<b>Light distribution:</b>	Symmetric
<b>Optics:</b>	Lens
<b>Beam angle:</b>	60°/90°
<b>Diffuser:</b>	ClearPMMA
<b>Warranty:</b>	5 Years standard warranty

**VADER 210** surface mounted luminaire

**VADER 210 PND** suspended luminaire

All current index numbers, lumen outputs, power consumption and many other technical information are available in our 2024 pricelist.

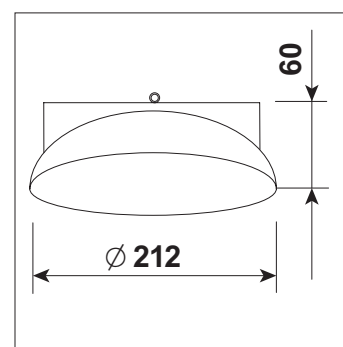

Basic dimensions



## VADER 210

Product code	Product name	Gross Lumen [lm]	Nett Lumen [lm]	Power [W]	Efficacy [lm/W]	Colour temperature [K]	Optics	Length [mm]	Width [mm]	Height [mm]	Nett Weight [kg]
13.00001.83.E.60.LNS	VADER 330 / 7100lm / 830 / E / 60 / LNS	7100	6670	39	171	3000	60°	Ø 215		80	1,6
13.00001.83.E.90.LNS	VADER 330 / 7100lm / 830 / E / 90 / LNS	7100	6670	39	171	3000	90°	Ø 215		80	1,6
13.00001.84.E.60.LNS	VADER 330 / 7100lm / 840 / E / 60 / LNS	7100	6670	39	171	4000	60°	Ø 215		80	1,6
13.00001.84.E.90.LNS	VADER 330 / 7100lm / 840 / E / 90 / LNS	7100	6670	39	171	4000	90°	Ø 215		80	1,6
13.00001.86.E.60.LNS	VADER 330 / 7100lm / 865 / E / 60 / LNS	7100	6670	40	167	6500	60°	Ø 215		80	1,6
13.00001.86.E.90.LNS	VADER 330 / 7100lm / 865 / E / 90 / LNS	7100	6670	40	167	6500	90°	Ø 215		80	1,6